



## Research Guide for Finding Records Pertaining to Mo'okū'auhau Kānaka



Compiled for:

**Ku'u Ēwe, Ku'u Piko, Ku'u Iwi, Ku'u Koko**

An Online Community Empowerment Series for Those with Kuleana to Mālama i nā Iwi Kūpuna

Compiled by:



HULIAUAPA'A

lulai 2020

# KU‘U ĒWE, KU‘U PIKO, KU‘U IWI, KU‘U KOKO: Mālama i nā Iwi Kūpuna



## Contents

Overview of This Research Guide .....	3
Organization of the Research Guide.....	3
Resources for Finding Information on Genealogy Records – The “Statehood”/Modern Era 1959 – 2020....	5
Resources for Finding Information on Genealogy Records - "Territory" Era 1900 – 1959.....	8
Resources for Finding Information on Genealogy Records - Kingdom Era 1810 – 1900 .....	13
Resources for Finding Information on Genealogy Records - Kalaupapa ‘Ohana.....	17
Resources for Finding Information on Genealogy Records - Additional Resources.....	18
Repository Diagrams.....	19
Hawai‘i State Archives.....	19
Hawai‘i State Public Library.....	20
Works Cited.....	23

Cover photo courtesy of Kā‘eo Izon

# KU‘U ĒWE, KU‘U PIKO, KU‘U IWI, KU‘U KOKO: Mālama i nā Iwi Kūpuna



## **Overview of This Research Guide**

The following tables are intended to assist in locating and acquiring records containing information about the birth, marriage and/or divorce, and death of family members for the purpose of compiling a database of genealogical information as may be used in asserting and receiving recognition for specific claims of descendancy to kūpuna within Ko Hawai‘i Pae ‘Āina.

Many other types of records exist that are useful in this form of research including, but not limited to, church records, census records, and mo‘olelo describing kūpuna prior to the unification of the islands under Kamehameha I in 1810. This guide is focused primarily on locating documents that aid in connecting us to kūpuna from the present time until 1810 as this time range is more pertinent to us in establishing genealogical ties for the purpose of preventing current desecration as may be imposed by modern development.

This guide is focused primarily on assisting you with finding birth, marriage and divorce, and death records from government repositories as these repositories are typically more easily accessible to the general public. Additional resources for locating documents for kūpuna who were sent to, or who ended up at Kalaupapa are also included.

## **Organization of the Research Guide**

**The tables are arranged first in order by general, and semi-arbitrarily delineated time periods as follows:**

- » “Statehood” until present, 1959 – 2020
- » The “Territorial” Era, 1900 – 1959
- » The Kingdom Era, 1810 – 1900

**Within each time period, the tables are arranged by the following types of documents:**

- » Birth Records
- » Marriage and Divorce Records
- » Death Records

**Within each type of record (Birth, Marriage/Divorce, and Death) the tables are further arranged by:**

- » Repository
- » Name of resource or finding aid
- » Date range of records (where available)
- » Physical location of the record or finding aid within the physical repository
- » URL where the documents or finding aids may be found (where available)
- » Notes and tips for searching the documents or finding aids

# KU‘U ĒWE, KU‘U PIKO, KU‘U IWI, KU‘U KOKO: Mālama i nā Iwi Kūpuna



## **Where available, these tables include information on:**

- » The physical locations of each resource within the repository
- » The date range of documents held within each collection
- » Notes and tips for searching each collection
- » Web addresses for resources that are accessible online

Additional tables are included to assist in finding information on kūpuna who lived at or were sent to Kalaupapa, and to provide additional resources for conducting mo‘okū‘auhau research in general.

Diagrams depicting the general layout of the Hawai‘i State Archives and the Hawai‘i State Public Library are included following the resource tables.

## Resources for Finding Information on Genealogy Records – The “Statehood”/Modern Era, 1959 – 2020

Birth Records in the “Statehood”/Modern Era, 1959 – 2020				
Repository	Resource Name	Date Range of Records	Location (Within Physical Office)	Notes
Department of Health (DOH) – Vital Records Office	DOH Vital Records Birth Certificate Order and Tracking	July 1909 – Present	Request birth certificates online at: <a href="https://vitrec.ehawaii.gov/vitalrecords/">https://vitrec.ehawaii.gov/vitalrecords/</a>	Must prove relation to receive certificate. Eligibility info is online: <a href="https://health.hawaii.gov/vitalrecords/death-certificates/#eligibility">https://health.hawaii.gov/vitalrecords/death-certificates/#eligibility</a>
Hawai‘i State Public Library	Delayed Birth Records Index	1859 – 1970	4 volumes kept at reference desk	Lists names of persons who applied for a Certificate of Hawaiian Birth ("Hawaiian" = born in Hawai‘i) up to 1970
				Library also has testimonies on microfilm, in support of applicants for these certificates born between Feb. 1904 and March 1913.
				From the Department of Health
				Search Alphabetically by: -Aahn - Hisaoka -Hisashima - Malaqui -Maldonado - Sasahara -Sasaki - Zukerau
Online	Chronicling America	1789 – 1963	<a href="https://chroniclingamerica.loc.gov/">https://chroniclingamerica.loc.gov/</a>	

Marriage and Divorce Records in the “Statehood”/Modern Era, 1959 – 2020				
Repository	Resource Name	Date Range of Records	Location (Within Physical Office)	Notes
Department of Health (DOH) – Vital Records Office	State and Territory of Hawai‘i Marriage Index	1896 – 2010	Request Marriage Certificates online at: <a href="https://vitrec.ehawaii.gov/vitalrecords/">https://vitrec.ehawaii.gov/vitalrecords/</a>	<b>Search by:</b> Groom’s surname Must prove relation to receive certificate. Eligibility info is online: <a href="https://health.hawaii.gov/vitalrecords/death-certificates/#eligibility">https://health.hawaii.gov/vitalrecords/death-certificates/#eligibility</a>
	State and Territory of Hawai‘i Divorce Index	1951 – 2001		<b>Search by:</b> Groom and Bride Must prove relation to receive certificate. Eligibility info is online: <a href="https://health.hawaii.gov/vitalrecords/death-certificates/#eligibility">https://health.hawaii.gov/vitalrecords/death-certificates/#eligibility</a>



### Death Records in the "Statehood"/Modern Era, 1959 – 2020

Repository	Resource Name	Date Range of Records	Location (Within Physical Office)	Notes
Hawai'i State Public Library	Index to the Honolulu Advertiser and the Honolulu Star-Bulletin	1929 – 1968		Indexes obituaries by year, then name.
				From 1929 – 1969, search under "death"
				From 1970 on, search under "obituaries"
				Not every death was listed as an obituary. Early listings may be very incomplete
	Hawai'i State Public Library System's Newspaper Index	1989 – present	<a href="http://ipac2.librarieshawaii.org:81/#focus">http://ipac2.librarieshawaii.org:81/#focus</a>	Covers obituaries in Honolulu Advertiser, and Honolulu Star Bulletin
				Search under person's name, and if known, the year of death
Department of Health (DOH)	Death Certificate, in-person application for certificates			Or do a browse search by person's last name.
				Death certificates are normally handled by the mortuary handling funeral arrangements
				Information on making requests for certificates can be found online at: <a href="https://health.hawaii.gov/vital-records/death-certificates/">https://health.hawaii.gov/vital-records/death-certificates/</a>

## Resources for Finding Information on Genealogy Records - "Territory" Era, 1900 – 1959

Birth Records in the "Territory" Era, 1900 – 1959				
Repository	Resource Name	Date Range of Records	Location (Within Physical Office)	Notes
Department of Health (DOH) – Vital Records Office	Territory of Hawai‘i Delayed Birth Index	Prior to 1931		Search by: Surname
	Territory of Hawai‘i Birth Index	1909 – 1955		
Hawai‘i State Public Library	Delayed Birth Records Index	1859 – 1970	4 volumes kept at reference desk	From the Department of Health
				Lists names of persons who applied for a Certificate of Hawaiian Birth ("Hawaiian" = born in Hawai‘i) up to 1970
				The Library also has testimonies supporting applications for certificates for applicants born between Feb. 1904 and March 1913 on microfilm
				Search Alphabetically by: -Aahn - Hisaoka -Hisashima - Malaqui -Maldonado - Sasahara -Sasaki - Zukerau
	Index to Territory of Hawai‘i Births	1896 – 1909	3 volumes, call number: H929.3 Hawt. Ask reference desk	Search By: -Name of child (*some babies not recorded at time of recordation) -Name of Mother -Name of Father
				Information includes: -District area -Name of parents -Birth date



### Birth Records in the "Territory" Era, 1900 – 1959

Repository	Resource Name	Date Range of Records	Location (Within Physical Office)	Notes
	Index to Birth Notices Published in Hawai'i's Newspapers	1850 – 1950	Microfilm, 1 reel	Compiled by the staff of the Hawai'i State Archives
	Index of Birth Certificates	July 1909 – December 1948	Microfilm, rolls #1 – #75	From the Department of Health
	Birth Certificates	1909 – 1921	Microfilm	From the Department of Health Check Index of Birth Certificates first to locate Birth Certificates
	Birth Certificates	July 1909 – December 1948	Microfilm, rolls #1 – #35	
	Delayed Birth Certificates	February 11, 1904 – March 28, 1913	Microfilm, rolls #266 – #355*	*Roll #344 is missing
Hawai'i State Archives	Birth Indexes	Hawai'i Island – 1900	Index drawers/ card catalogue on makai side of reading room	
	Birth Notices, Marriages, and Obituaries		Index drawers/ card catalogue by back door to circulation	
	Vital Statistics Collection	1826 – 1929	Physical collection. Also available online at <a href="https://digitalcollections.hawaii.gov/greenstone3/library">https://digitalcollections.hawaii.gov/greenstone3/library</a>	A limited number of birth records are available online. Images are still being scanned and added
Online Newspaper Databases	Chronicling America	1789 – 1963	<a href="https://chroniclingamerica.loc.gov/">https://chroniclingamerica.loc.gov/</a>	English-language newspapers
	Ulu kau: Hawaiian Electronic Library		<a href="https://nupepa.org/">https://nupepa.org/</a>	Hawaiian-language newspapers
	Papakilo Database		<a href="https://www.papakilodatabase.com/">https://www.papakilodatabase.com/</a>	Hawaiian-language newspapers

### Marriage and Divorce Records in the "Territory" Era, 1900 – 1959

Repository	Resource Name	Date Range of Records	Location (Within Physical Office)	Notes
Department of Health (DOH) – Vital Records Office	State and Territory of Hawai‘i Marriage Index	1896 – 2010	Request Marriage Certificates online at: <a href="https://vitrec.ehawaii.gov/vitalrecords/">https://vitrec.ehawaii.gov/vitalrecords/</a>	<b>Search by:</b> Groom’s surname
				Must prove relation to receive certificate. Eligibility info is online: <a href="https://health.hawaii.gov/vitalrecords/death-certificates/#eligibility">https://health.hawaii.gov/vitalrecords/death-certificates/#eligibility</a>
	State and Territory of Hawai‘i Divorce Index	1951 – 2001		<b>Search by:</b> Groom and Bride
				Must prove relation to receive certificate. Eligibility info is online: <a href="https://health.hawaii.gov/vitalrecords/death-certificates/#eligibility">https://health.hawaii.gov/vitalrecords/death-certificates/#eligibility</a>
Hawai‘i State Public Library	Index of Marriages Published in Hawai‘i’s Newspapers	1850 – 1950	Microfilm, 1 reel, kept at reference desk	From the Hawai‘i State Archives
	Index to Marriages: By Name of Groom	July 1909 – June 1949	Microfilm, rolls #104 – #127	
	Index to Marriages: By Name of Bride	July 1909 – June 1949	Microfilm, rolls #128 – #150	
	Index to Marriages: By Area	July 1909 – November 1920	Microfilm, rolls #77 – #85	
Hawai‘i State Archives	Birth Notices, Marriages, and Obituaries		Index drawers/ card catalogue by back door to circulation	
	Marriage Records Index		Blue books at mauka side of reading room	
	Vital Statistics Collection	1826 – 1929	Physical collection. Also available online at <a href="https://digitalcollections.hawaii.gov/greenstone3/library">https://digitalcollections.hawaii.gov/greenstone3/library</a>	Limited marriage and divorce records are available online. Images are still being scanned and added.

### Marriage and Divorce Records in the "Territory" Era, 1900 – 1959

Repository	Resource Name	Date Range of Records	Location (Within Physical Office)	Notes
Ulukau.org	Hawaiian Genealogy Indexes > Marriage	1826 – 1929	<a href="http://ulukau.org/algene/cgi-bin/algene">http://ulukau.org/algene/cgi-bin/algene</a>	Index to marriage records from 1826 – 1929 as found in the Hawai'i State Archives Collection
	Hawaiian Genealogy Indexes > Divorce	1848 – 1915	<a href="http://ulukau.org/algene/cgi-bin/algene">http://ulukau.org/algene/cgi-bin/algene</a>	Index to divorce case files

### Death Records in the "Territory" Era, 1900 - 1959

Repository	Resource Name	Date Range of Records	Location (Within Physical Office)	Notes
Hawai'i State Public Library	Index of Death Certificates	July 1909 – December 1920	Microfilm, rolls #76 – #103	
	Death Certificates	July 1909 – December 1920	Microfilm	
	Index to Obituaries Published in Hawai'i's Newspapers	1836 – 1950	Microfilm, 4 reels, kept at reference desk	Compiled by the staff of the Hawai'i State Archives
	Index to the Honolulu Advertiser & Honolulu Star-Bulletin	1929 – 1994		Indexes obituaries by year, then name.
				From 1929 – 1969, search under "death"
				From 1970 on, search under "obituaries"
				Not every death was listed as an obituary. Early listings may be very incomplete
Hawai'i State Archives	Vital Statistics Collection	1826 – 1929	Physical collection. Also available online at <a href="https://digitalcollections.hawaii.gov/greenstone3/library">https://digitalcollections.hawaii.gov/greenstone3/library</a>	Limited death records are available online. Images are still being scanned and added.
Ulukau.org	Hawaiian Genealogy Indexes > Deaths > Probates Index		<a href="http://ulukau.org/algene/cgi-bin/algene">http://ulukau.org/algene/cgi-bin/algene</a>	First through fifth circuit
	Hawaiian Genealogy Indexes > Deaths > Probates Minute Books		<a href="http://ulukau.org/algene/cgi-bin/algene">http://ulukau.org/algene/cgi-bin/algene</a>	Third through fifth circuit
	Hawaiian Genealogy Indexes > Deaths > Wills	1852 – 1916	<a href="http://ulukau.org/algene/cgi-bin/algene">http://ulukau.org/algene/cgi-bin/algene</a>	First circuit and other circuits
Social Security Administration	Death Information Files	The Social Security Act (SSA) was passed in 1935, and	<a href="https://www.ssa.gov/dataexchange/request_dmf.html">https://www.ssa.gov/dataexchange/request_dmf.html</a>	Full files of death are shared only with certain State and Federal Agencies

		the first benefits were paid out in 1940		Files of death include (if available): -Deceased individual's social security number -First name, middle name, surname -Date of Birth -Date of Death
--	--	--	--	--

### Resources for Finding Information on Genealogy Records - Kingdom Era, 1810 – 1900

Birth Records in the Kingdom Era, 1810 – 1900				
Repository	Resource Name	Date Range of Records	Location (Within Physical Office)	Notes
Hawai'i State Public Library	Delayed Birth Records Index	1859 – 1970	4 volumes kept at reference desk	<p>From the Dept. of Health</p> <p>Lists names of persons who applied for a Certificate of Hawaiian Birth ("Hawaiian" = born in Hawai'i) up to 1970</p> <p>The Library also has testimonies supporting applications for certificates for applicants born between February 1904 and March 1913 on microfilm</p> <p>Search Alphabetically by:</p> <ul style="list-style-type: none"> <li>-Aahn - Hisaoka</li> <li>-Hisashima - Malaqui</li> <li>-Maldonado - Sasahara</li> <li>-Sasaki - Zukerau</li> </ul>
	Index to Territory of Hawai'i Births	1896 – 1909	(3 volumes) Call number: H929.3 Hawt. Ask reference desk	<p>Search By:</p> <ul style="list-style-type: none"> <li>-Name of child (*some babies not recorded at time of recordation)</li> <li>-Name of Mother</li> <li>-Name of Father</li> </ul>

### Birth Records in the Kingdom Era, 1810 – 1900

Repository	Resource Name	Date Range of Records	Location (Within Physical Office)	Notes
				Information includes: -District area -Name of parents -Birth date
	Index to Birth Notices Published in Hawai'i's Newspapers	1850 – 1950	Microfilm, 1 reel	Compiled by the staff of the Hawai'i State Archives
Hawai'i State Archives	Birth Indexes	Birth: <ul style="list-style-type: none"> <li>• Hawai'i Island: 1855 – 1861, 1869 – 1897, 1900</li> <li>• Maui: 1860 – 1864, 1899</li> <li>• O'ahu: 1852 – 1885</li> <li>• Ni'ihau: 1853 – 1856</li> </ul>	Index drawers/ card catalogue on makai side of reading room	
	Birth Notices, Marriages, and Obituaries		Index drawers/ card catalogue by back door to circulation	
	Vital Statistics Collection	1826 – 1929	Physical collection. Also available online at <a href="https://digitalcollections.hawaii.gov/greenstone3/library">https://digitalcollections.hawaii.gov/greenstone3/library</a>	A limited number of birth records are available online. Images are still being scanned and added



### Marriage and Divorce Records in the Kingdom Era, 1810 – 1900

Repository	Resource Name	Date Range of Records	Location (Within Physical Office)	Notes
Department of Health – Vital Records Office	State & Territory of Hawai‘i Marriage Index	1896 – 2010	Request Marriage Certificates online at: <a href="https://vitrec.ehawaii.gov/vitalrecords/">https://vitrec.ehawaii.gov/vitalrecords/</a>	<b>Search by:</b> Groom’s surname Must prove relation to receive certificate. Eligibility info is online: <a href="https://health.hawaii.gov/vitalrecords/death-certificates/#eligibility">https://health.hawaii.gov/vitalrecords/death-certificates/#eligibility</a>
Hawai‘i State Public Library	Index of Marriages Published in Hawai‘i’s Newspapers	1850 – 1950	Microfilm, 1 reel, kept at reference desk	From the Hawai‘i State Archives
Hawai‘i State Archives	Birth Notices, Marriages, and Obituaries		Index drawers/ card catalogue by back door to circulation	
	Marriage Records Index		Blue books at mauka side of reading room	
	Vital Statistics Collection	1826 – 1929	Physical collection. Also available online at <a href="https://digitalcollections.hawaii.gov/greenstone3/library">https://digitalcollections.hawaii.gov/greenstone3/library</a>	Limited marriage and divorce records are available online. Images are still being scanned and added.
Ulukau.org	Hawaiian Genealogy Indexes > Marriage	1826 – 1929	<a href="http://ulukau.org/algene/cgi-bin/algene">http://ulukau.org/algene/cgi-bin/algene</a>	Index to marriage records from 1826 – 1929 as found in the Hawai‘i State Archives Collection
	Hawaiian Genealogy Indexes > Divorce	1848 – 1915	<a href="http://ulukau.org/algene/cgi-bin/algene">http://ulukau.org/algene/cgi-bin/algene</a>	Index to divorce case files

### Death Records in the Kingdom Era, 1810 – 1900

Repository	Resource Name	Date Range of Records	Location (Within Physical Office)	Notes
Hawai'i State Archives	Birth & Death Indexes	Death: • Hawai'i Island: 1853 – 1898 • Maui: 1860 – 1864, 1897 – 1899 • O'ahu: 1852 – 1873 • Ni'ihau: 1852, 1855 – 1856	Index drawers/ card catalogue at makai side of reading room	
	Vital Statistics Collection	1826 – 1929	Physical collection. Also available online at <a href="https://digitalcollections.hawaii.gov/greenstone3/library">https://digitalcollections.hawaii.gov/greenstone3/library</a>	Limited death records are available online. Images are still being scanned and added.
Hawai'i State Public Library	Index to Obituaries Published in Hawai'i's Newspapers	1836 – 1950	Microfilm, 4 reels, kept at reference desk	Compiled by the staff of the Hawai'i State Archives
Ulukau.org	Hawaiian Genealogy Indexes > Deaths > Probates Index		<a href="http://ulukau.org/algene/cgi-bin/algene">http://ulukau.org/algene/cgi-bin/algene</a>	First through fifth circuit
	Hawaiian Genealogy Indexes > Deaths > Probates Minute Books		<a href="http://ulukau.org/algene/cgi-bin/algene">http://ulukau.org/algene/cgi-bin/algene</a>	Third through fifth circuit
	Hawaiian Genealogy Indexes > Deaths > Wills	1852 – 1916	<a href="http://ulukau.org/algene/cgi-bin/algene">http://ulukau.org/algene/cgi-bin/algene</a>	First circuit and other circuits

## Resources for Finding Information on Genealogy Records - Kalaupapa 'Ohana

Kalaupapa Records				
Repository	Resource Name	Date Range of Records	Location (Within Physical Office)	Notes
Hawai'i State Archives	Kalaupapa Records: Persons apprehended, persons examined,		Book One	
	Kalaupapa Records: Persons examined,		Book Two	
	Kalaupapa Records: Deaths			
	Kalaupapa Records: Marriages			
	Kalaupapa Records: Births, parents, census, divorces			
Hawai'i State Public Library	Register of Voters > Molokai & Lāna'i > (Kalawao to Kalaupapa)	1887 – 1888	Microfilm, roll #14	

## Resources for Finding Information on Genealogy Records - Additional Resources

Additional Resources			
Repository	Resource Name	Location (Physical or Online)	Notes
AVA Konohiki.org	AVA Konohiki: Ancestral Visions of 'Āina	<a href="http://www.avakonohiki.org/">http://www.avakonohiki.org/</a>	Maps by island and moku; Mahele documents including LCAs, Foreign Testimonies and Native Testimonies. Video lectures from the Kamakakūokalani Center for Hawaiian Studies HWST 341 genealogies course.
Papakilo Database	Papakilo Database	<a href="https://www.papakilodatabase.com/">https://www.papakilodatabase.com/</a>	A collection of newspapers, Mahele documents and genealogy resources.
Kīpuka Database	Kīpuka Database	<a href="http://kipukadatabase.com/">http://kipukadatabase.com/</a>	A geospatially referenced database containing maps, Mahele documents, TMK information, information on registered historic sites, crown lands and more.
UH Mānoa Hamilton Library	Hawai'i Genealogy: Ethnic Groups Research Guide	<a href="https://guides.library.manoa.hawaii.edu/genealogyhawaiiethnic">https://guides.library.manoa.hawaii.edu/genealogyhawaiiethnic</a>	A guide and collection of resources to aid in conducting genealogy research in Hawai'i by ethnicity.
	Hawai'i Genealogy: General Resources Research Guide	<a href="https://guides.library.manoa.hawaii.edu/genealogyhawaii">https://guides.library.manoa.hawaii.edu/genealogyhawaii</a>	A guide and collection of resources to aid in conducting genealogy research in Hawai'i in general.
	Hawai'i Genealogy: Native Hawaiian Resources Research Guide	<a href="https://guides.library.manoa.hawaii.edu/genealogyhawaiian">https://guides.library.manoa.hawaii.edu/genealogyhawaiian</a>	A guide and collection of resources to aid in conducting genealogy research on ethnically Hawaiian kūpuna.
Bishop Museum Library and Archives	Bishop Museum Library and Archives Website	<a href="https://www.bishopmuseum.org/library-and-archives/">https://www.bishopmuseum.org/library-and-archives/</a>	Search the library and archive database for names of kupuna.
Kani 'Āina	Kani 'Āina: Voices of the Land	<a href="http://ulukau.org/kaniaina/?l=en">http://ulukau.org/kaniaina/?l=en</a>	A collection of oral histories that includes the Ka Leo Hawai'i collection and the Kū i ka Manaleo collection.
UH Mānoa Ethnic Studies Department, Center for Oral Histories	UH Mānoa Ethnic Studies Dept., Center for Oral Histories Website	<a href="https://ethnicstudies.manoa.hawaii.edu/center-for-oral-history/">https://ethnicstudies.manoa.hawaii.edu/center-for-oral-history/</a>	A collection of transcribed oral histories.
Edith McKinzie and Ishmael Stagner	Hawaiian Genealogies Volume 1	Book	Genealogies extracted from Hawaiian Language newspapers.
	Hawaiian Genealogies Volume 2	Book	Genealogies extracted from Hawaiian Language newspapers.

## Repository Diagrams

### Hawai'i State Archives

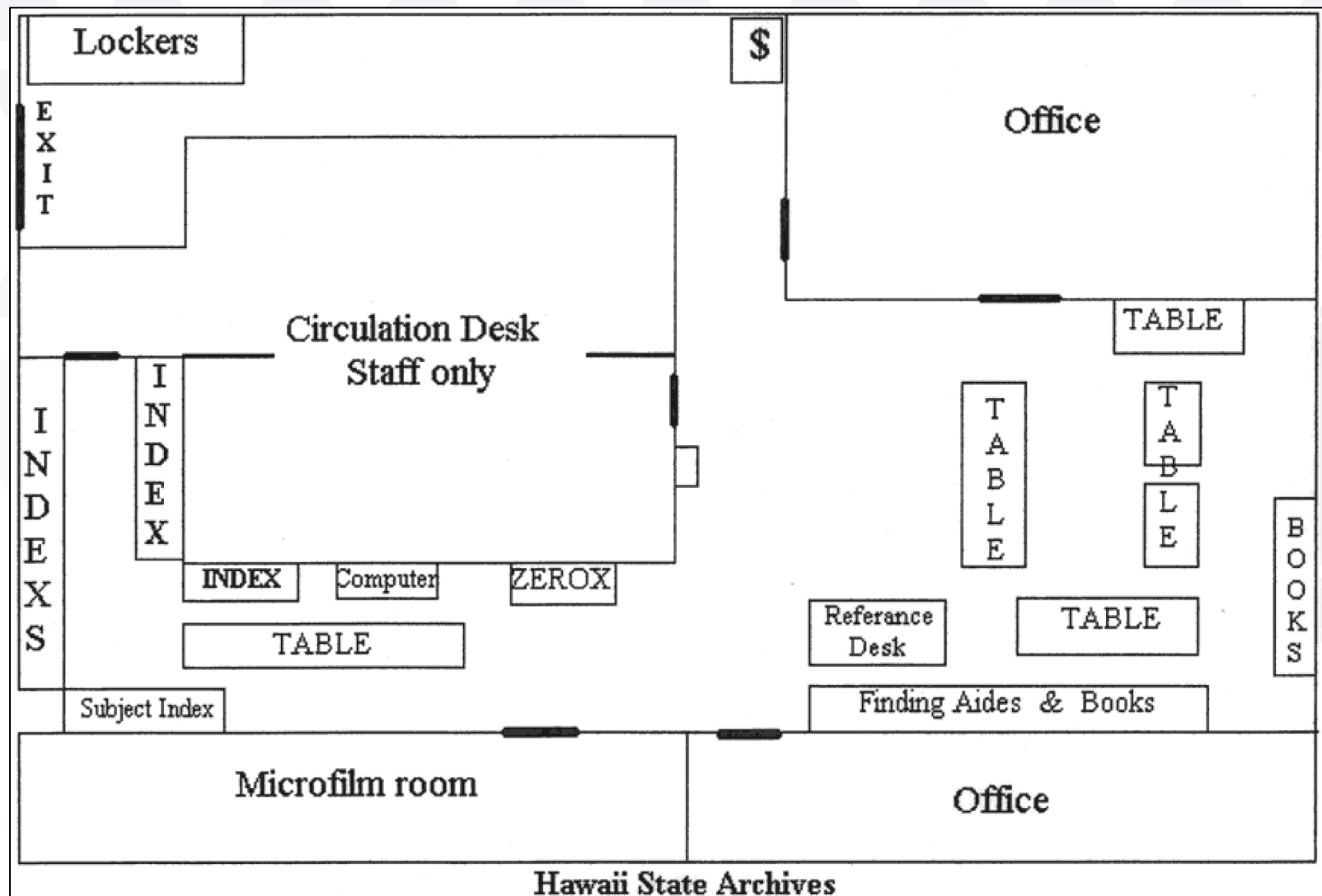

Figure 1. Diagram of the Hawai'i State Archives Interior Layout as taken from Rev. Joel Hulu Mahoe Research Center n.d. page 13.

## Hawai'i State Public Library

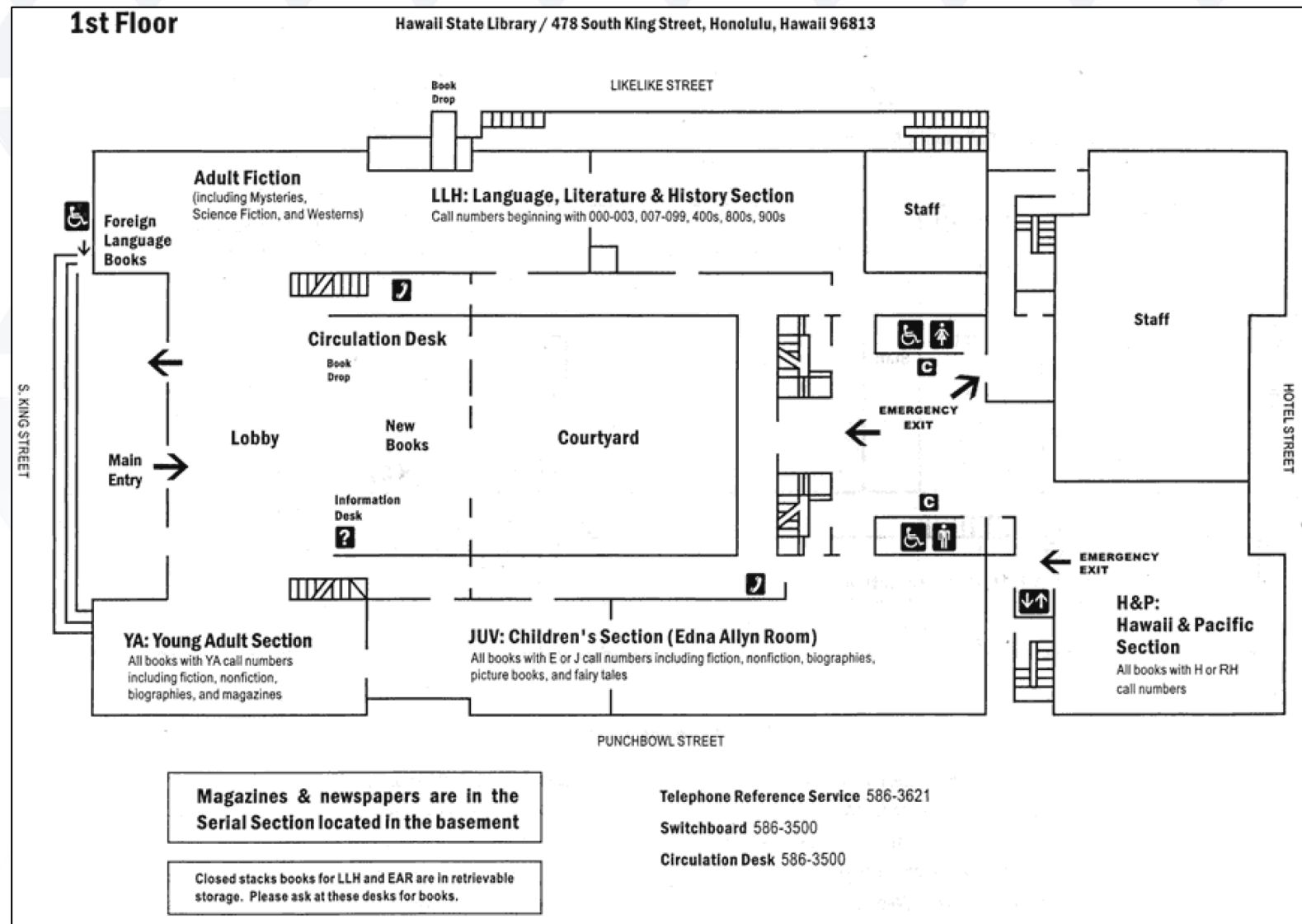

Figure 2. Diagram of the first floor of the Hawai'i State Public Library as taken from Reverend Joel Hulu Mahoe Research Center n. d., page 80.



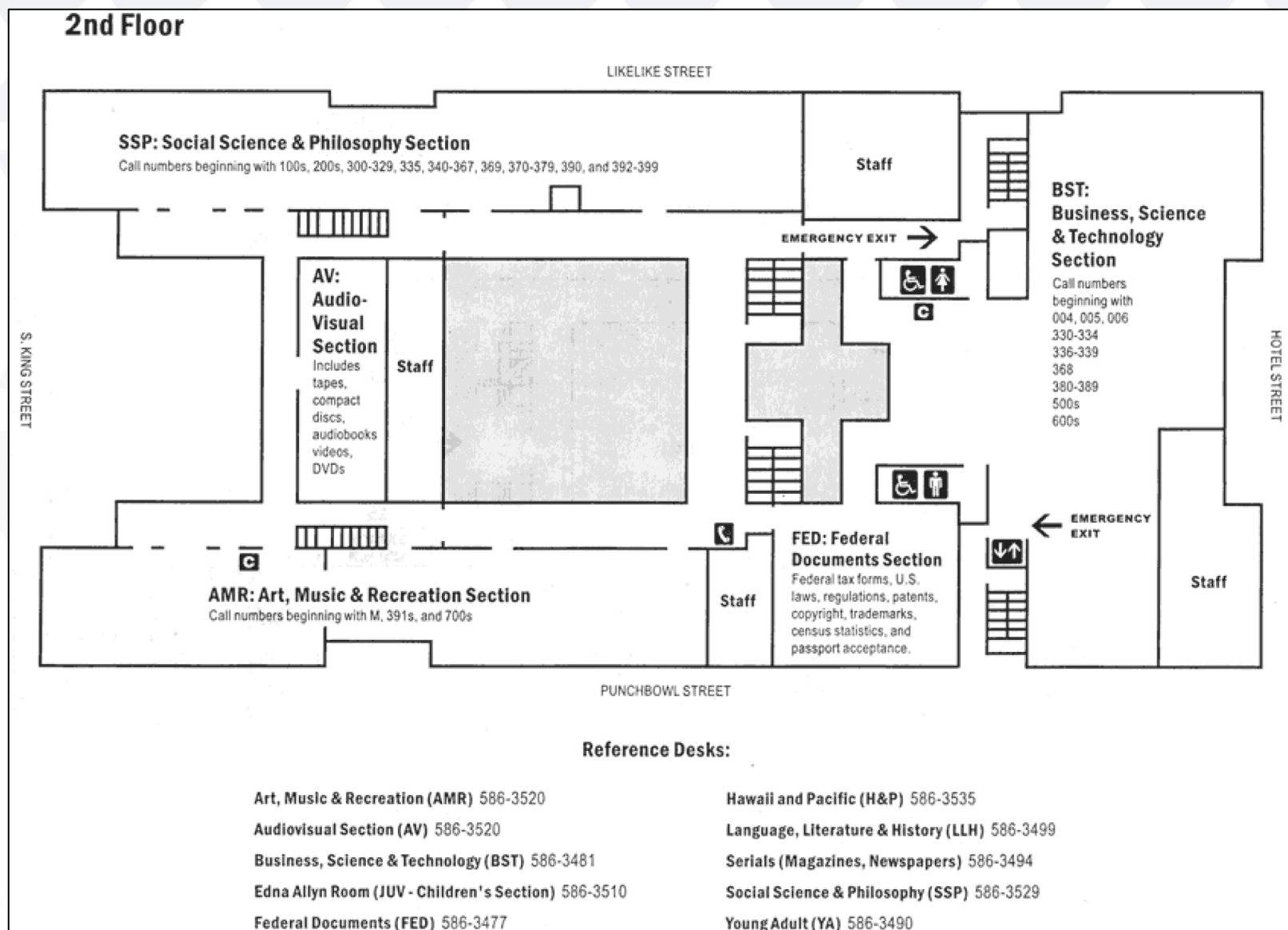

Figure 3. Diagram of the second floor of the Hawai'i State Public Library as taken from Reverend Joel Hulu Mahoe Research Center n. d. page 81.

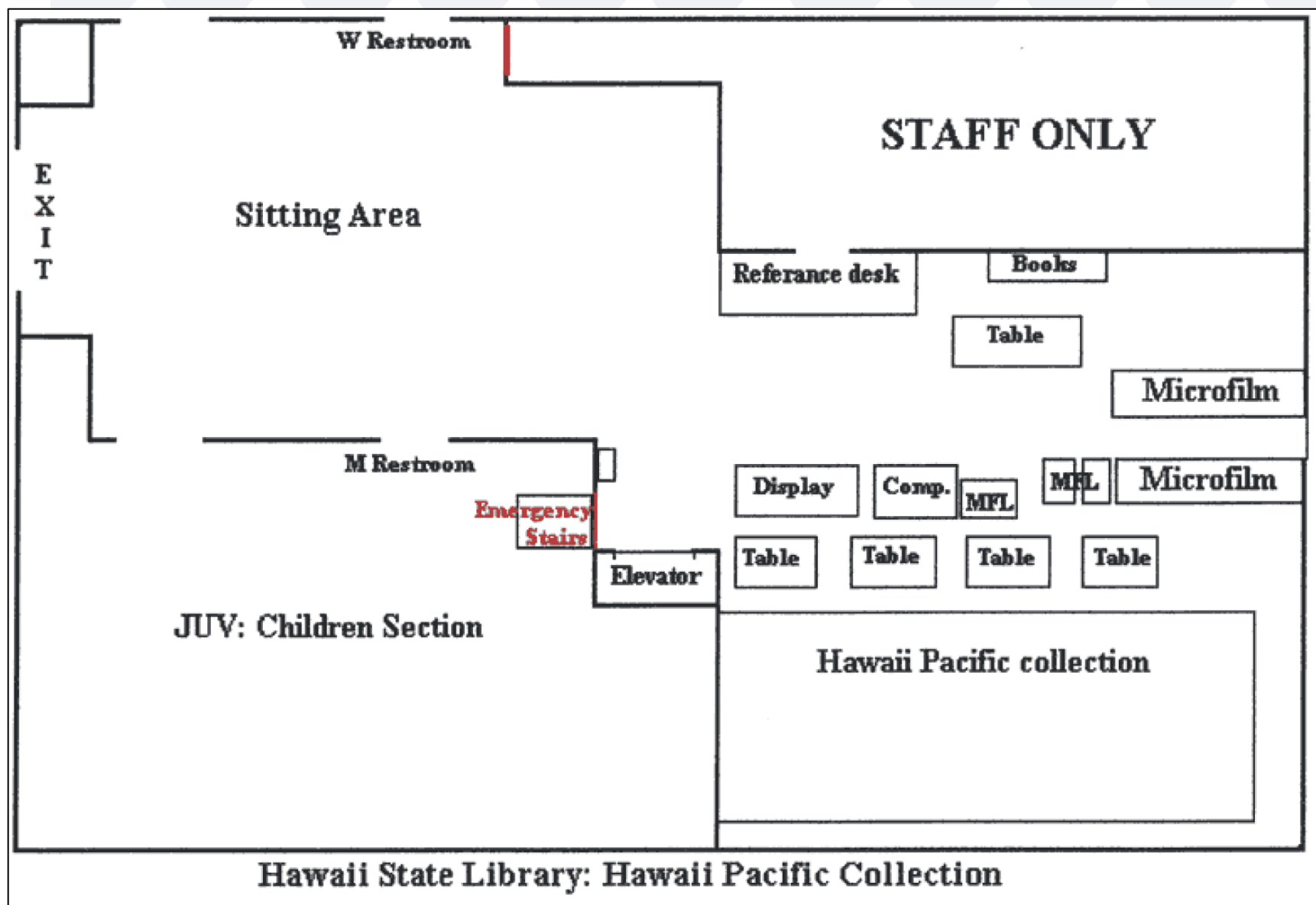

Figure 4. Diagram of the Hawai'i Pacific Collection in the Hawai'i State Public Library as taken from Reverend Joel Hulu Mahoe Research Center n. d. page 81A.

# KU‘U ĒWE, KU‘U PIKO, KU‘U IWI, KU‘U KOKO: Mālama i nā Iwi Kūpuna



## **Works Cited**

### **Reverend Joel Hulu Mahoe Research Center**

n. d. A Research Manual on Information Access and Retrieval of Genealogical and Land Information From Government Repositories in the State of Hawai‘i. Reverend Joel Hulu Mahoe Research Center, Honolulu.